

Map No 1

Surveyed February to May 1914
Verified Toronto June 1914
Forwarded June 17th 1914
Drawn by George Cooper Esquire
for C. Gordon Fisheries
June 2nd 1914

Tuggerah Lake

Proclamation Area
Mud and Sand Flats
5 1/2 ft
2 ft
1 ft

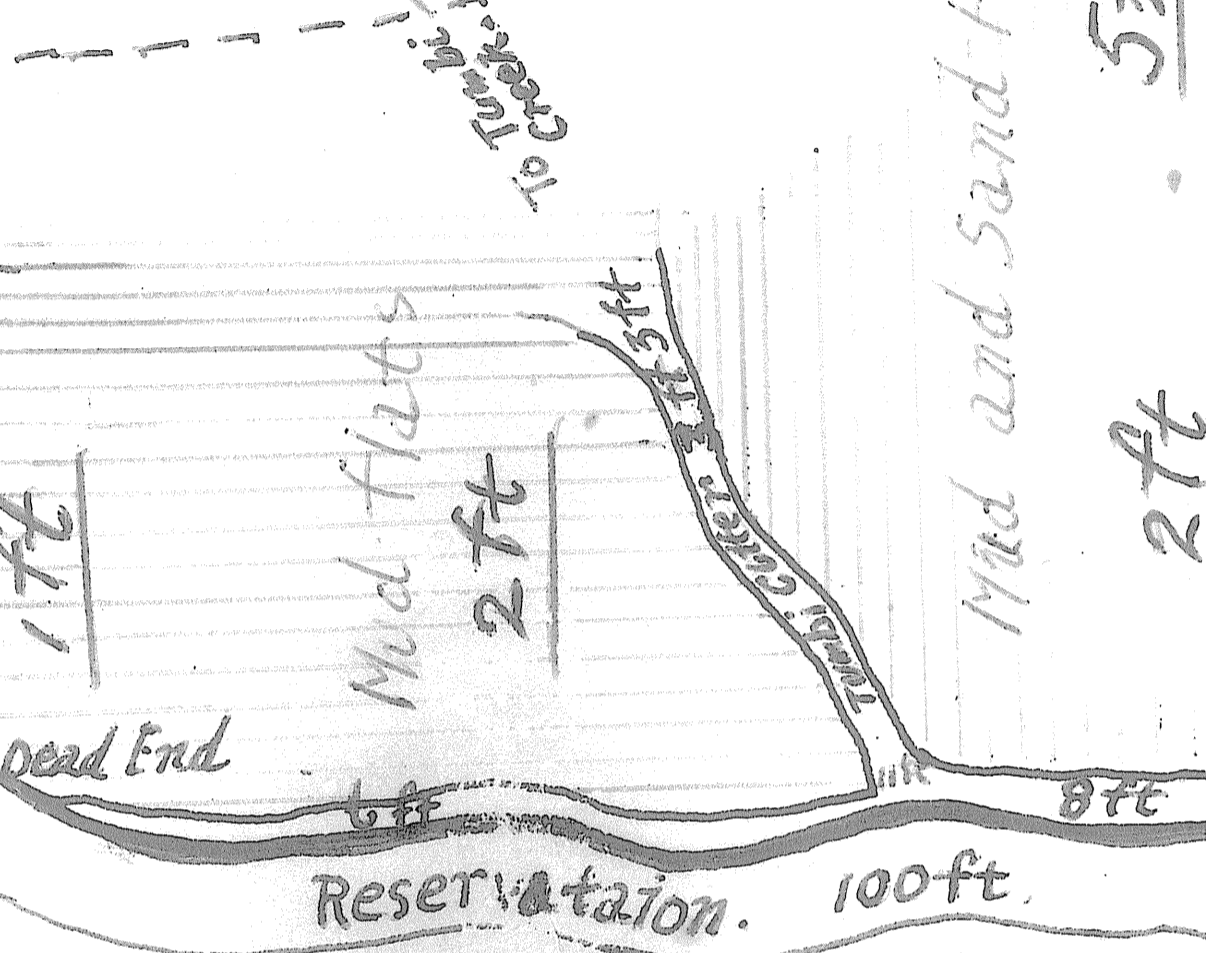

Proclamation Area At The Entrance Showing All Deep Navigable Channels And Waters. at high tide.

The Entrance

Ka Pa Qi
Denniss - Tuggerah House

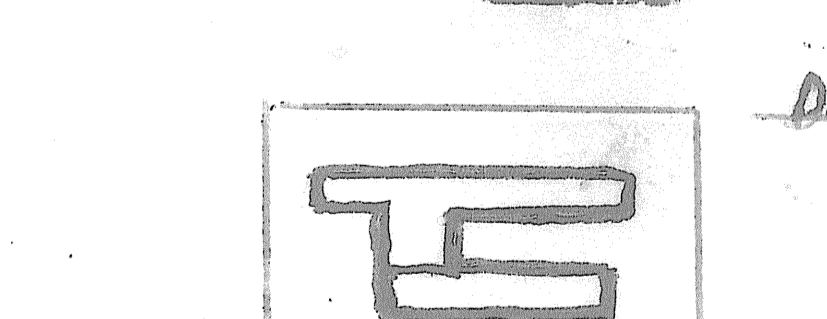

Dening Bayview

Depths at High Tide

C. Gordon Fisheries The Entrance
4th July 1914

- L. Taylor's Houses
- Bradley Fisheries
- Pinehurst
- I. Taylor
- Louis Taylor
- V.C. Taylor

- Bradley's Wharf
- Fisheries wharf
- Government wharf 24 ft
- Taylor's Ferry
- WOOD'S P.O.
- CASCOCK'S P.O. 18 ft

Duffy's Store

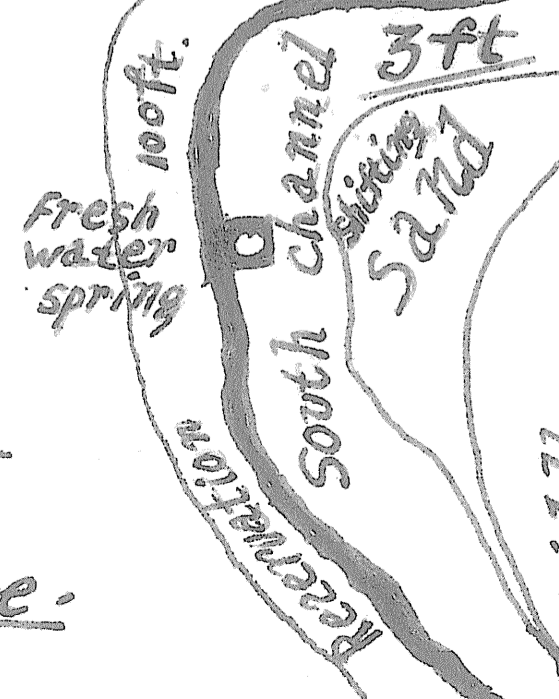

High Tide By And Large 2 ft

Middle Channel 5 ft

Shifting Tidal sand Flat
Stretches South East To The Entrance channel
in many acres. and continues until the time

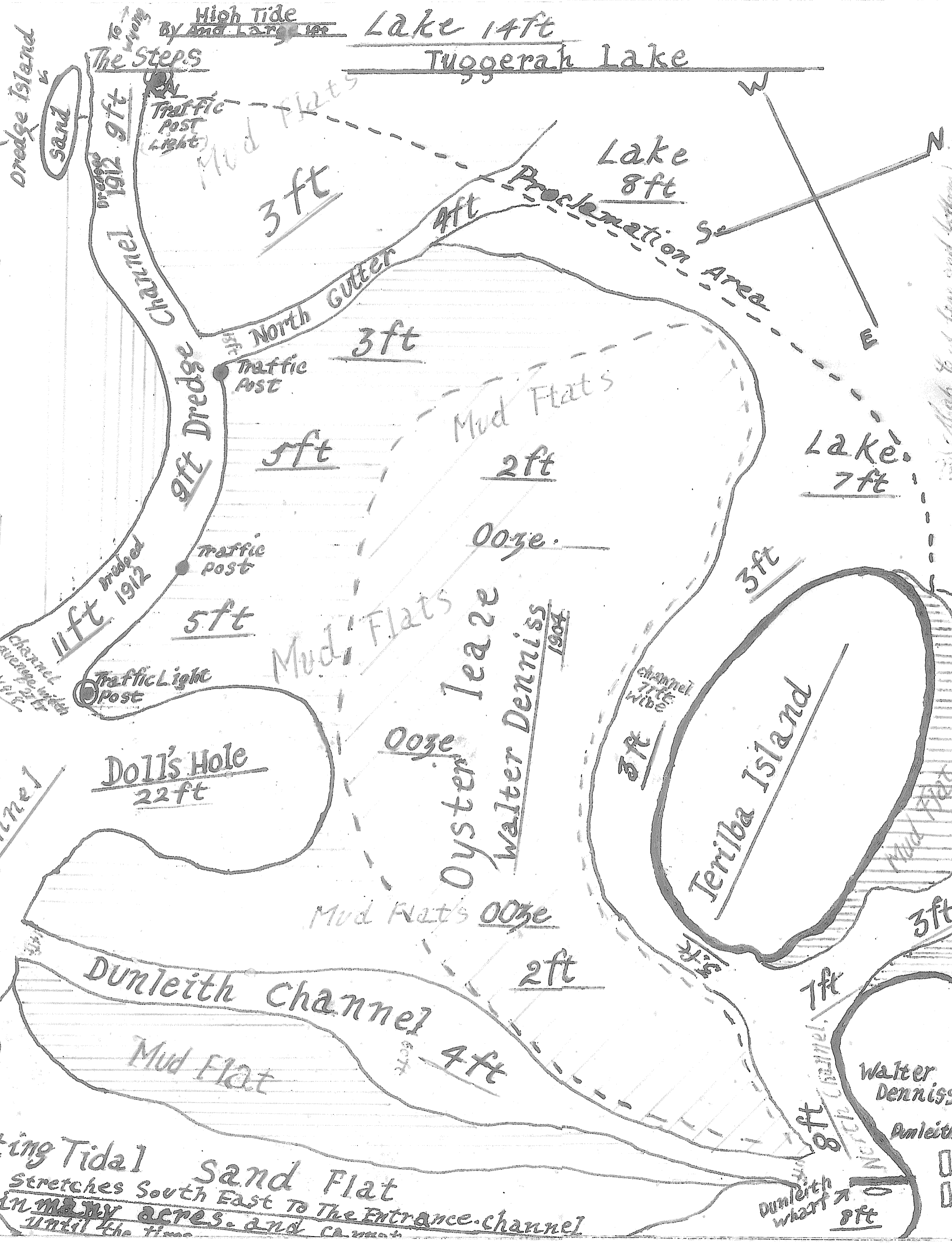

Map of the lake and bottom